

# INDEPENDENT BREAKERS

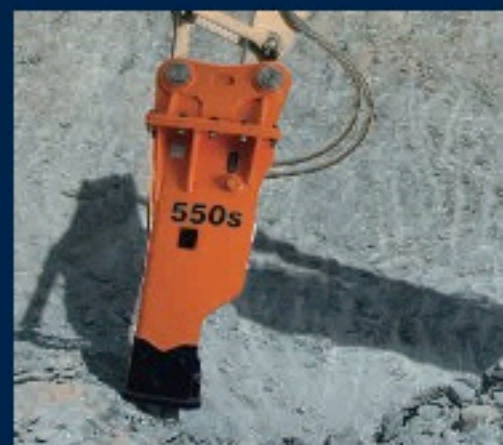

[IndependentBreakers.com](http://IndependentBreakers.com)



**POWERFUL/STRONG/HIGHLY EFFICIENT/SERVICE GUARANTEED**

**INDEPENDENT BREAKERS**  
HYDRAULIC BREAKERS & ATTACHMENTS





## ABOUT INDEPENDENT **BREAKERS**

*Independent Breakers plays a significant role in the hydraulic hammer & attachment industry. We have the ability to support any size contractor, business, or dealer. Our primary goal is to offer excellent quality products at an unbeatable price.*

*The reason we can offer our products at unbeatable prices is because we strive to keep our overhead low while buying direct from the manufacturer. Buying direct from the manufacturer guarantees that you will get the absolute best price. Our manufacturer is always maintaining the highest quality products.*

*We feel by maintaining a healthy company that we will always offer great products. With this approach we maintain a positive determination to increase competitiveness throughout the industry.*



# PRODUCTION PROCESS

From raw material control to Complete products!

STEP 01



MATERIAL ENTERING CUTTING

STEP 02



FACING

STEP 03



CNC PROCESSING

STEP 04

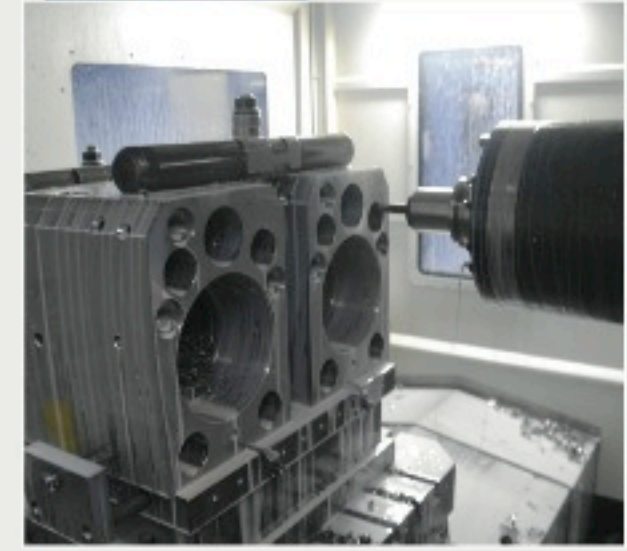

MCT PROCESSING

STEP 05



Heat Treatment

STEP 06

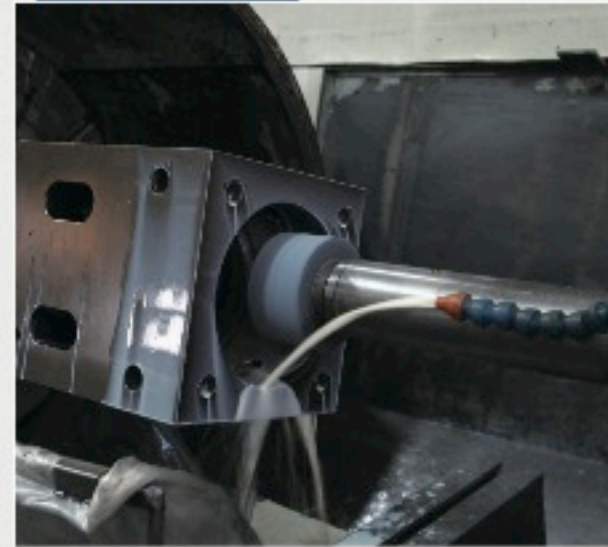

Grinding

STEP 07



Assembly

STEP 08



packaging, shipping



# INNER-MOUNTED SYSTEM

## SILENCED BOX TYPE

- Noise reduction technology!
- Environmentally friendly!
- High quality & maximum durability!

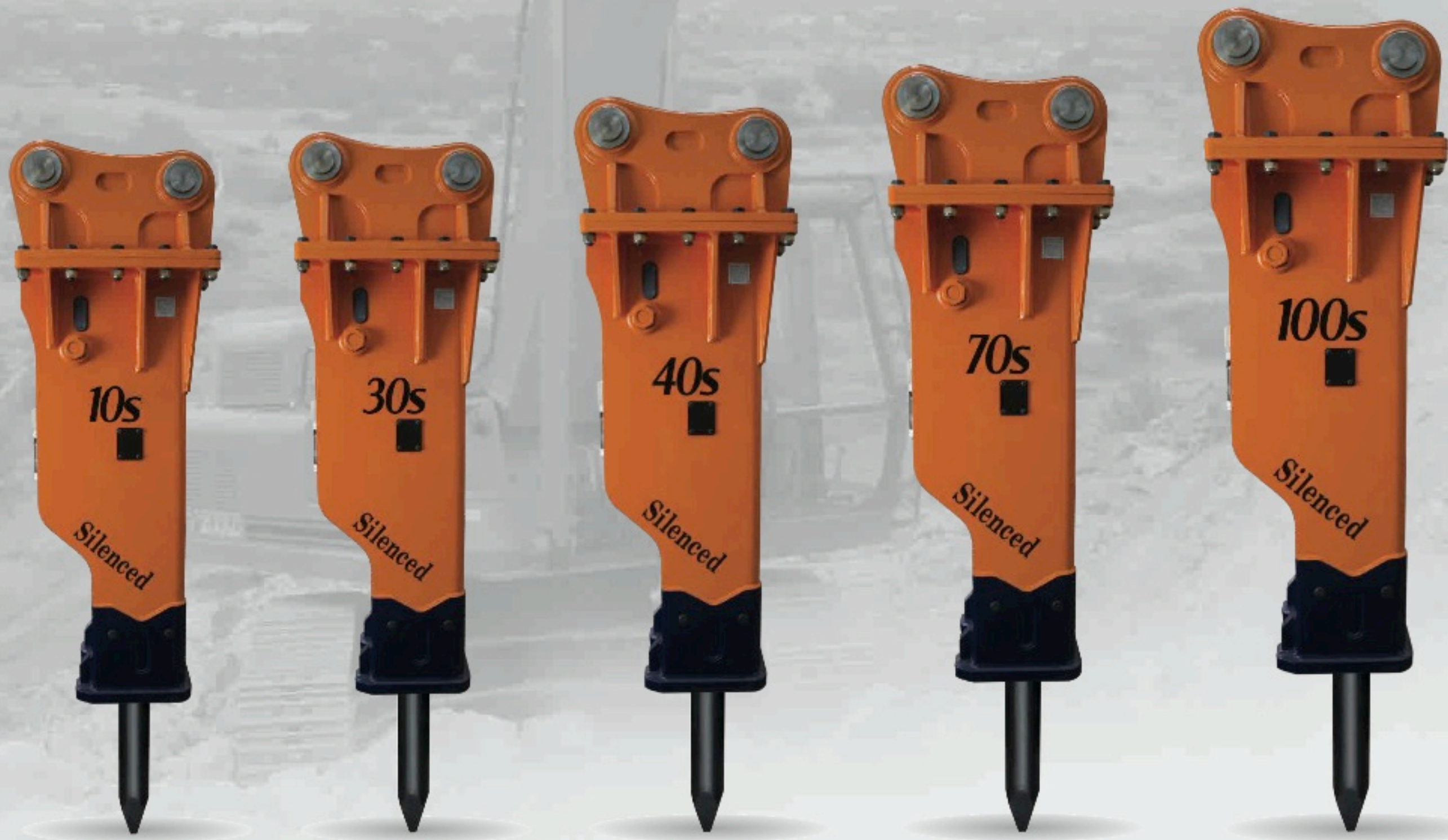

### Standard Specification

Description / Model	UNIT	10S	20S	30S	35S	40S	50S
Operating Weight	Kg	100	120	216	226	320	445
	lbs	220	264	475	497	704	979
Setting Pressure	bar	140	140	150	150	160	180
	psi	2,030	2,030	2,175	2,175	2,320	2,611
Operating Pressure	bar	90 ~ 120	90 ~ 120	90 ~ 120	90 ~ 120	110 ~ 140	120 ~ 150
	psi	1,280 ~ 1,707	1,280 ~ 1,707	1,280 ~ 1,707	1,280 ~ 1,707	1,565 ~ 1,991	1,707 ~ 2,134
Oil Flow Range	l/min	15 ~ 25	20 ~ 30	25 ~ 40	25 ~ 50	40 ~ 70	50 ~ 90
	gal/min	4 ~ 7	5 ~ 8	7 ~ 11	6.5 ~ 13	10.5 ~ 18.5	13 ~ 24
Impact Rate	bpm	700 ~ 1,200	700 ~ 1,200	600 ~ 1,100	600 ~ 1,100	500 ~ 900	400 ~ 800
Hose Diameter	inch	1/2	1/2	1/2	1/2	1/2	1/2
Tool Shank Diameter	mm/inch	40 / 1.6	45 / 1.8	53 / 2.1	58 / 2.3	68 / 2.7	75 / 2.9
Applicable Carrier Weight	ton	0.5 ~ 1.5	1.2 ~ 3.0	2.5 ~ 4.5	3.0 ~ 4.5	4 ~ 7	6 ~ 9
	lbs	1,102 ~ 3,306	2,645 ~ 6,613	5,511 ~ 9,920	5,511 ~ 9,920	8,818 ~ 15,432	13,227 ~ 19,841
Noise Level	L <sub>a</sub> (dB)	85	90	89	89	89	88

Light duty range
  Medium duty range
  Heavy duty range

☒ Above specification can be changed without any prior notice for improvement in quality



70S	100S	160S	200S	250S	380S	400S	500S	550S
600	928	1,460	1,705	1,948	2,290	2,890	3,140	4,075
1,320	2,042	3,212	3,751	4,286	5,038	6,358	6,922	8,965
180	190	210	210	210	230	230	250	250
2,611	2,756	3,046	3,046	3,046	3,336	3,336	3,626	3,626
130 ~ 160	150 ~ 170	150 ~ 170	160 ~ 180	160 ~ 180	160 ~ 180	160 ~ 180	160 ~ 180	160 ~ 180
1,849 ~ 2,276	2,134 ~ 2,418	2,176 ~ 2,466	2,276 ~ 2,560	2,276 ~ 2,560	2,276 ~ 2,560	2,276 ~ 2,560	2,276 ~ 2,560	2,276 ~ 2,560
60 ~ 100	80 ~ 110	90 ~ 120	100 ~ 150	120 ~ 180	140 ~ 190	180 ~ 240	200 ~ 260	210 ~ 290
16 ~ 26.5	21 ~ 29	24 ~ 32	27 ~ 40	32 ~ 48	37 ~ 50	48 ~ 63	51 ~ 69	55 ~ 77
400 ~ 800	450 ~ 630	450 ~ 700	350 ~ 600	350 ~ 500	300 ~ 450	300 ~ 450	250 ~ 400	200 ~ 350
3/4	3/4	1	1	1	1	1-1/4	1-1/4	1-1/4
85 / 3.3	100 / 3.9	125 / 4.9	135 / 5.3	140 / 5.5	150 / 5.9	155 / 6.1	165 / 6.5	175 / 6.9
7 ~ 14	11~16	16 ~ 22	18 ~ 21	18 ~ 26	23 ~ 28	28 ~ 35	30 ~ 45	40 ~ 55
15,432~30,864	24,250~35,274	35,270~48,500	39,683~46,297	39,683~57,320	50,706 ~ 61,729	61,729~77,161	66,138~99,208	88,185~121,254
88	88	88	86	85	87	90	91	92

Light duty range
  Medium duty range
  Heavy duty range

☒ Above specification can be changed without any prior notice for improvement in quality

# OUTER-MOUNTED SYSTEM

## SILENCED BOX TYPE

- Noise reduction technology!
- Environmentally friendly!
- High quality & maximum durability!



### Optional

#### Auto lubricant system



- ☑ Auto lubricant system
- ☑ Auto lubricant system with its grease cartridges automatically delivers the exact amount of grease during operation.
- ☑ This makes the demolition impact smoother and extends the bush & tool life.



• Standard Specification

Description / Model	UNIT	150S	220S	350S	450S
Operating Weight	Kg	1,240	1,816	2,450	3,380
	lbs	2,728	3,995	5,390	7,436
Setting Pressure	bar	210	210	230	230
	psi	3,046	3,046	3,336	3,336
Operating Pressure	bar	150 ~ 180	160 ~ 180	160 ~ 180	160 ~ 180
	psi	2,176 ~ 2,611	2,276 ~ 2,560	2,276 ~ 2,560	2,276 ~ 2,560
Oil Flow Range	l/min	90 ~ 120	100 ~ 150	150 ~ 210	190 ~ 250
	gal/min	24 ~ 32	27 ~ 40	40 ~ 56	50 ~ 66
Impact Rate	bpm	450 ~ 700	400 ~ 600	300 ~ 450	300 ~ 600
Hose Diameter	inch	1	1	1	1-1/4
Tool Shank Diameter	mm/inch	120 / 4.7	135 / 5.3	150 / 5.9	160 / 6.3
Applicable Carrier Weight	ton	13 ~ 20	18 ~ 26	25 ~ 30	35 ~ 48
	lbs	28,660 ~ 44,100	39,683 ~ 46,297	55,115 ~ 66,138	77,161 ~ 105,821
Noise Level	L <sub>p</sub> (dB)	89	86	84	84

Medium duty range      Heavy duty range

\*Above specification can be changed without any prior notice for improvement in quality.

## INNER-MOUNTED SYSTEM

# SM TOP TYPE

- Ready to work!
- High quality & outstanding durability!
- Priority system for customer satisfaction!



### Standard Specification

Description / Model	UNIT	10T	20T	30T	35T	40T	50T
Operating Weight	Kg	80	100	196	206	298	375
	lbs	176	220	431	453	656	825
Setting Pressure	bar	140	140	150	150	160	180
	psi	2,030	2,030	2,175	2,175	2,320	2,611
Operating Pressure	bar	90 ~ 120	90 ~ 120	90 ~ 120	90 ~ 120	110 ~ 140	120 ~ 150
	psi	1,280 ~ 1,707	1,280 ~ 1,707	1,280 ~ 1,707	1,280 ~ 1,707	1,565 ~ 1,991	1,707 ~ 2,134
Oil Flow Range	l/min	15 ~ 25	20 ~ 30	25 ~ 40	25 ~ 50	40 ~ 70	50 ~ 90
	gal/min	4 ~ 7	5 ~ 8	7 ~ 11	6.5 ~ 13	10.5 ~ 18.5	13 ~ 24
Impact Rate	bpm	700 ~ 1,200	700 ~ 1,200	600 ~ 1,100	600 ~ 1,100	500 ~ 900	400 ~ 800
Hose Diameter	inch	1/2	1/2	1/2	1/2	1/2	1/2
Tool Shank Diameter	mm/inch	40 / 1.6	45 / 1.8	53 / 2.1	58 / 2.3	68 / 2.7	75 / 2.9
Applicable Carrier Weight	ton	0.5 ~ 1.5	1.2 ~ 3.0	2.5 ~ 4.5	3.0 ~ 4.5	4 ~ 7	6 ~ 9
	lbs	1,102 ~ 3,306	2,645 ~ 6,613	5,511 ~ 9,920	5,511 ~ 9,920	8,818 ~ 15,432	13,227 ~ 19,841
Noise Level	L <sub>A</sub> (dB)	85	90	89	89	89	88

Light duty range    Medium duty range    Heavy duty range

\*Above specification can be changed without any prior notice for improvement in quality.



70T	100T	160T	200T	250T	380T	400T	500T	550T
577	908	1,431	1,675	1,936	2,237	2,838	3,065	4,002
1,269	1,998	3,148	3,685	4,259	4,921	6,244	6,743	8,804
180	190	210	210	210	230	230	250	250
2,611	2,756	3,046	3,046	3,046	3,336	3,336	3,626	3,626
130 ~ 160	150 ~ 170	150 ~ 170	160 ~ 180	160 ~ 180	160 ~ 180	160 ~ 180	160 ~ 180	160 ~ 180
1,849 ~ 2,276	2,134 ~ 2,418	2,176 ~ 2,466	2,276 ~ 2,560	2,276 ~ 2,560	2,276 ~ 2,560	2,276 ~ 2,560	2,276 ~ 2,560	2,276 ~ 2,560
60 ~ 100	80 ~ 110	90 ~ 120	100 ~ 150	120 ~ 180	140 ~ 190	180 ~ 240	200 ~ 260	210 ~ 290
16 ~ 26.5	21 ~ 29	24 ~ 32	27 ~ 40	32 ~ 48	37 ~ 50	48 ~ 63	51 ~ 69	55 ~ 77
400 ~ 800	450 ~ 630	450 ~ 700	350 ~ 600	350 ~ 500	300 ~ 450	300 ~ 450	250 ~ 400	200 ~ 350
3/4	3/4	1	1	1	1	1-1/4	1-1/4	1-1/4
85 / 3.3	100 / 3.9	125 / 4.9	135 / 5.3	140 / 5.5	150 / 5.9	155 / 6.1	165 / 6.5	175 / 6.9
7 ~ 14	11~16	16 ~ 22	18 ~ 21	18 ~ 26	23 ~ 28	28 ~ 35	30 ~ 45	40 ~ 55
15,432~30,864	24,250~35,274	35,270~48,500	39,683~46,297	39,683~57,320	50,706 ~ 61,729	61,729~77,161	66,138~99,208	88,185~121,254
88	88	88	86	85	87	90	91	92

Light duty range
  Medium duty range
  Heavy duty range

\*Above specification can be changed without any prior notice for improvement in quality.

# INNER-MOUNTED SYSTEM

## BACKHOE LOADER TYPE SKID STEER LOADER TYPE



Backhoe Loader (Normal type)



Backhoe Loader (BoxType)



Skid Steer (Loader Type)

### ▪ Backhoe Loader type

Description / Model	UNIT	30BL	35BL	40BL	50BL
Operating Weight	BOX(Kg/lbs)	226 / 497	236 / 519	330 / 726	460 / 1,012
	Normal(Kg/lbs)	206 / 453	216 / 475	308 / 678	390 / 858
Setting Pressure	bar	150	150	160	180
	psi	2175	2175	2320	2611
Operating Pressure	bar	90 ~ 120	90 ~ 120	110 ~ 140	120 ~ 150
	psi	1,280 ~ 1,707	1,280 ~ 1,707	1,565 ~ 1,991	1,707 ~ 2,134
Oil Flow Range	l/min	25 ~ 40	25 ~ 50	40 ~ 70	50 ~ 90
	gal/min	7 ~ 11	6.5 ~ 13	10.5 ~ 18.5	13 ~ 24
Impact Rate	bpm	600 ~ 1,100	600 ~ 1,100	500 ~ 900	400 ~ 800
Hose Diameter	inch	1/2	1/2	1/2	1/2
Tool Shank Diameter	mm/inch	53 / 2.1	58 / 2.3	68 / 2.7	75 / 2.9
Applicable Carrier Weight	ton	2.5 ~ 4.5	3.0 ~ 4.5	4 ~ 7	6 ~ 9
	lbs	5,511 ~ 9,920	5,511 ~ 9,920	8,818 ~ 15,432	13,227 ~ 19,841
Noise Level	L <sub>p</sub> (dB)	89	89	89	88

### ▪ Skid Steer Loader type

	30SL	35SL	40SL
	256 / 563	269 / 592	365 / 803
	226 / 497	236 / 519	343 / 755
	150	150	160
	2175	2175	2,320
	90 ~ 120	90 ~ 120	110 ~ 140
	1,280 ~ 1,707	1,280 ~ 1,707	1,565 ~ 1,991
	25 ~ 40	25 ~ 50	40 ~ 70
	7 ~ 11	6.5 ~ 13	10.5 ~ 18.5
	600 ~ 1,100	600 ~ 1,100	500 ~ 900
	1/2	1/2	1/2
	53 / 2.1	58 / 2.3	68 / 2.7
	2.5 ~ 4.5	3.0 ~ 4.5	4 ~ 7
	5,511 ~ 9,920	5,511 ~ 9,920	8,818 ~ 15,432
	89	89	89

\*Above specification can be changed without any prior notice for improvement in quality.

# PARTS

## GENUINE PARTS

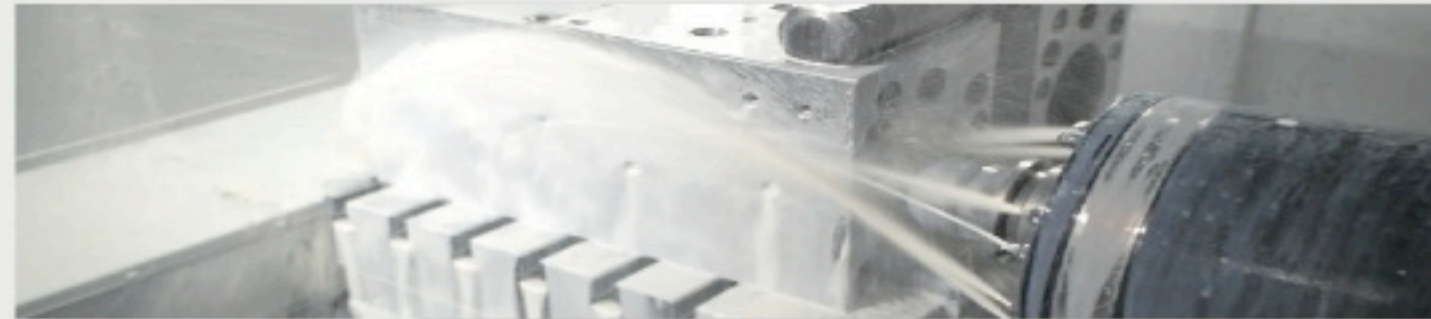

### • Breaker Parts



•CYLINDER



•FRONT HEAD



•BACK HEAD



•PISTON

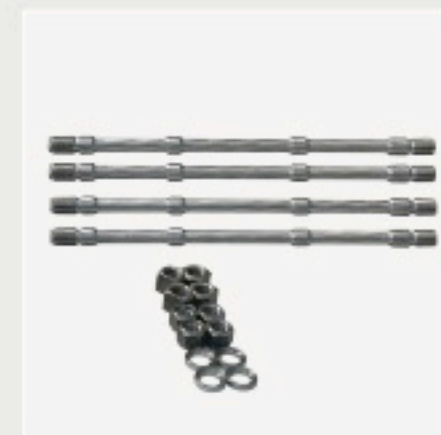

•THROUGH BOLT



•ACC SET



•CYLINDER



•FRONT HEAD



•BACK HEAD



•PISTON



•SIDE BOLT



•PIN SET



•SEAL HOUSING



•THRUST BUSH



•TOOL BUSH



•VALVE HOUSING



•VALVE SET



•SEAL KIT

### • Rod (Tool)



#### MOIL POINT

Universal usage  
Concrete breaking  
Rock breaking  
Road construction



#### CONE

Universal usage  
Soft & nonabrasive work



#### CHISEL

Mining  
Trenching  
Ground work  
Slope breaking



#### ASPHALT CUTTER

Frozen ground  
Asphalt cutting



#### BLUNT

Mining  
Block holing  
Secondary breaking  
Slag removal

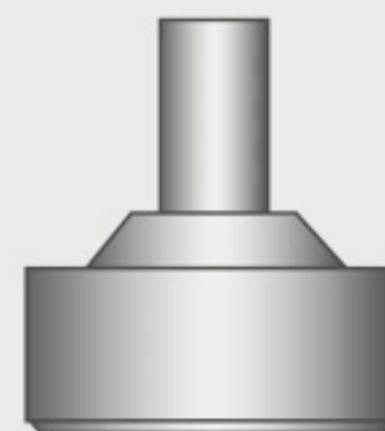

#### SLAB BUSTER

Slab demolishing  
Lower tool wear application

# INNER-MOUNTED SYSTEM

## Structure & Features

### 1 Energy Regeneration Nitrogen Gas Cushion Chamber(ERNGCC)

Absorb's piston's upward recoil and conducts energy recycling for the constant blow.

### 2 GUIDE BUFFER

Side vibration absorber and side suspension device to protect the powercell.

### 3 N2 Gas Charged Accumulator

Rechargeable N2 gas accumulator to assist power stroke and to reduce the surge pressure and spikes from the hydraulic circuit of the excavator.

### 4 Piston

Most efficient design for maximum energy transfer and recoil reduction as well as ideal match of tool and piston diameters. It transfers highest shock wave into the breaking objects.

### 5 Dual Rod Pins

Correct tool alignment and dispersion of tool wear.

### 6 Working Rod

Heat treated and optimal length for efficient breaking.

### 7 Auto Grease Refiller

Compact auto-grease refiller is equipped as an optional feature. Eaily refill is serviced and continuous greasing is available as long as the breaker is operated. (Not shown on illustration)

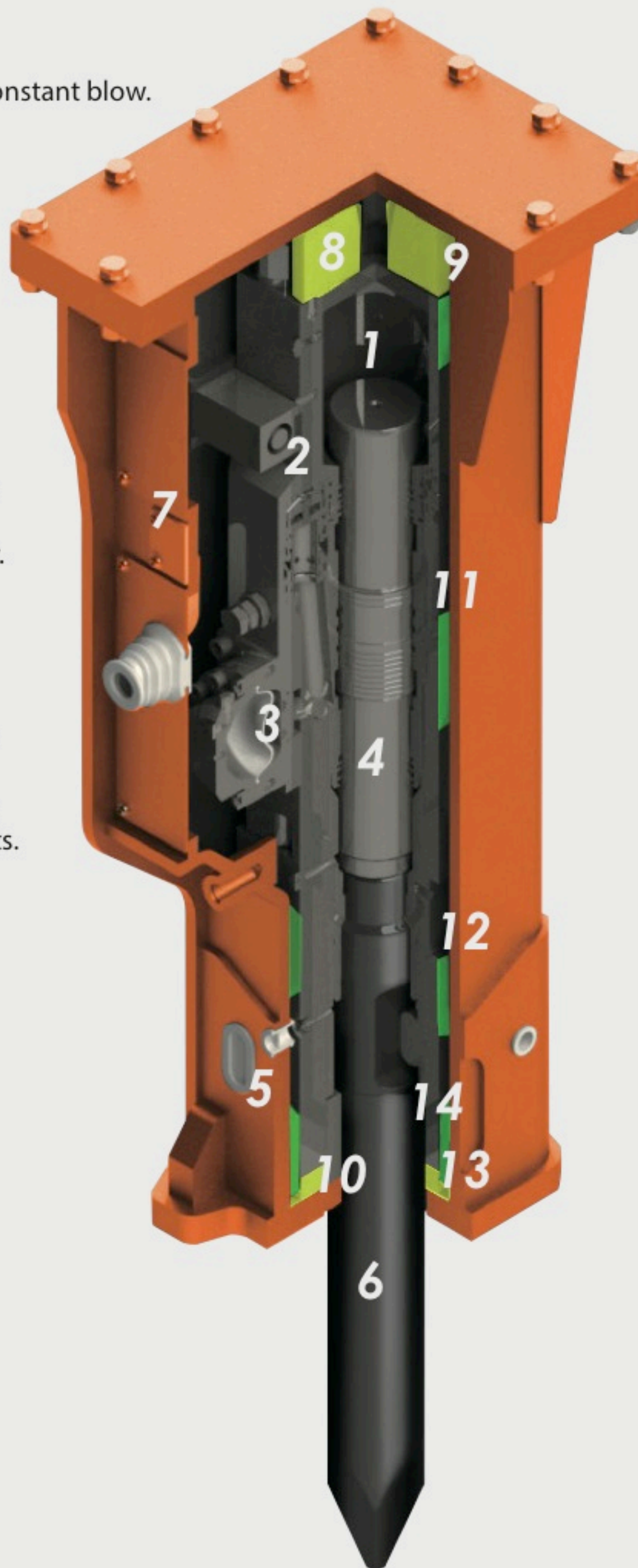

### 8 UPPER DAMPER

Vibration absorber to prevent the impulses between carrier and the breaker.

### 9 Through Bolt

Fully closed side(tie) rods increases the durability and the optimal load carrying capacity is designed.

### 10 DOWN DAMPER

Vibration absorber and suspension device to protect the powercell.

### 11 Cylinder Design

Square typed cylinder design brings optimum match between back head and front head as well as improves stable operation to increase the products durability and to reduce unnecessary damages such as scratches.

### 12 All-in One Type of Upper Bushing and Thrust Ring Integration

Convenient one set thats easier to maintenance and service without disassembly of powercell.

### 13 Wearing Plates

Employment of wear resistant plates between cylinder, front head and housing, increases the overall product durability.

### 14 Replaceable Tool Bushing

Convenient for the replacement of and to protect the head. (Not shown in illustration)

# Structure & Features



## 1 Energy Regeneration Nitrogen Gas Cushion Chamber(ERNGCC)

Absorbs the piston's upward recoil and conduct energy recycling for the constant blow.

## 2 GUIDE BUFFER

Side vibration absorber and side suspension device to protect the powercell.

## 3 N2 Gas Charged Accumulator

Rechargeable N2 gas accumulator to assist power stroke and to reduce the surge pressure and the spikes from the hydraulic circuit of the excavator.

## 4 Piston

Most efficient design for maximum energy transfer and recoil reduction as well as ideal match of tool and piston diameters. Transfers the highest shock wave into the breaking objects.

## 5 Dual Rod Pins

Correct tool alignment and dispersion of tool wear.

## 6 Working Rod

Heat treated and optimal length for efficient breaking.

## 7 Auto Grease Refiller

Compact auto grease refiller is equipped as an optional feature. Easy daily refill is serviced and continuous greasing is available as long as the breaker is operated.  
(Not shown on the illustration)

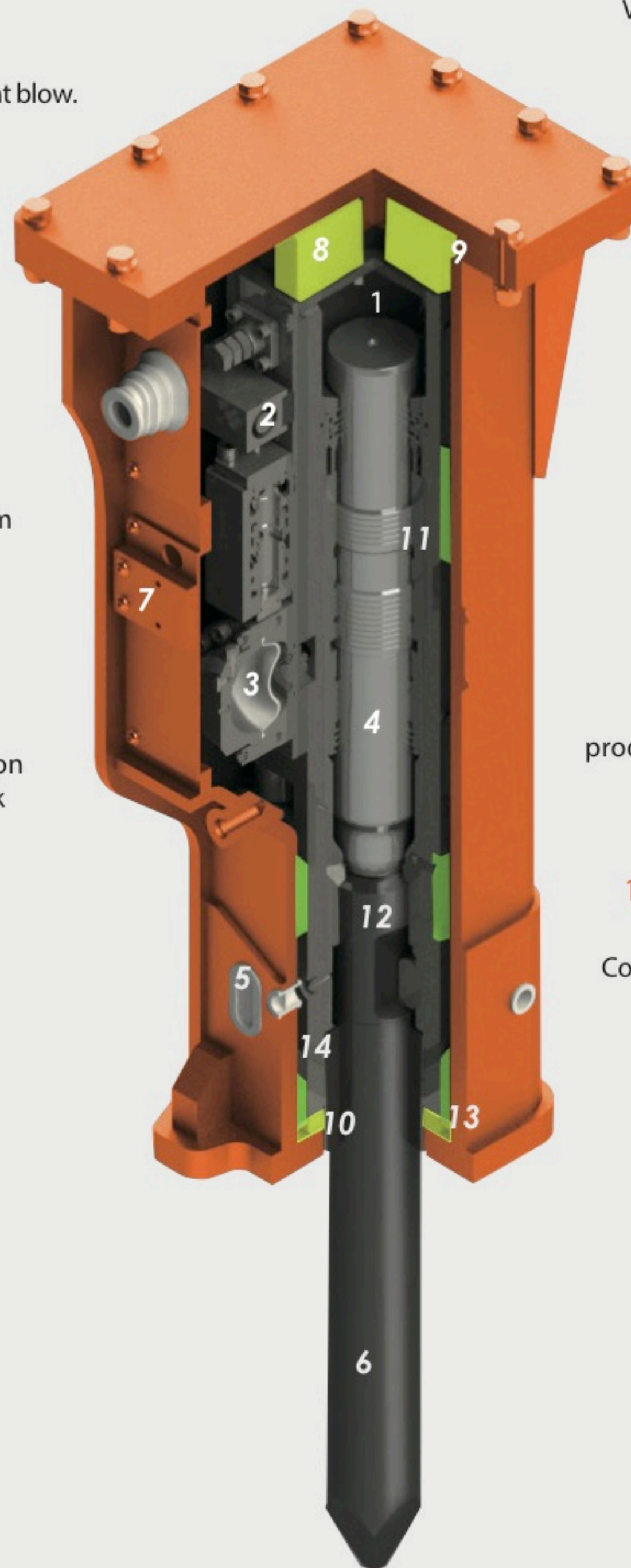

## 8 UPPER DAMPER

Vibration absorber to prevent the impulses between the carrier and the breaker.

## 9 Through Bolt

Fully closed side(tie) rods increases the durability and the optimal load carrying capacity.

## 10 DOWN DAMPER

Vibration absorber and suspension device to protect the powercell.

## 11 Cylinder Design

Square type cylinder design brings optimum match between back head and front head as well as improves stable operation to increase the product durability and to reduce unnecessary damages such as scratches.

## 12 All-in One Type of Upper Bushing and Thrust Ring Integration

Convenient one set and easier maintenance and serviceability without disassembly of powercell

## 13 Wearing Plates

Employment of wear resistant plates between cylinder, front head and housing increases the overall product durability.

## 14 Replaceable Tool Bushing

Convenience for replacement and protect the head.  
(Not shown on the illustration)

# ATTACHMENT Series

## Attachments

### Quick Coupler

#### Benefits

- The strongest durability on the same class prolongs its life.
- Double safety device
- Shorten the working hours with fast removable coupler
- Enough room for the safety pin

#### Standard Specification

Description / Model	UNIT	30	60	80	100	140	170	200
Operating Weight	Kg	54 ~ 60	150 ~ 163	340	520	650	725	890
	lbs	119 ~ 132	330 ~ 359	748	1,144	1,430	1,595	1,958
Length (L)	mm	575 ~ 593	814 ~ 820	970	1,080	1,125	1,226	1,285
Height (H)	mm	285	378	491	552	584	612	662
Width (W)	mm	249 ~ 259	408 ~ 423	469 ~ 503	543 ~ 593	574 ~ 624	630 ~ 670	680 ~ 710
Installation Width (W1)	mm	155 ~ 165	260 ~ 275	306 ~ 340	350 ~ 410	410 ~ 432	410 ~ 440	670 ~ 710
Applicable Carrier Weight	ton	2.5 ~ 4.5	7 ~ 14	16 ~ 22	18 ~ 26	28 ~ 35	35 ~ 45	45 ~ 55
	lbs	5,511 ~ 9,920	15,432 ~ 30,864	35,270 ~ 48,500	39,683 ~ 57,320	61,729 ~ 77,161	77,161 ~ 99,208	99,208 ~ 121,254

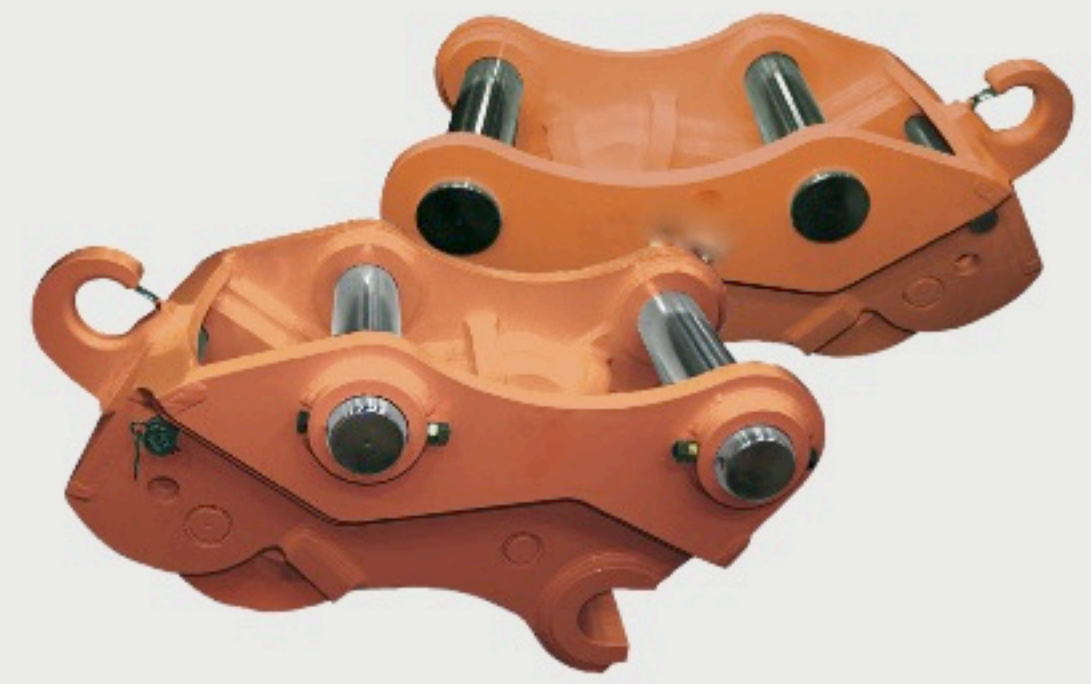
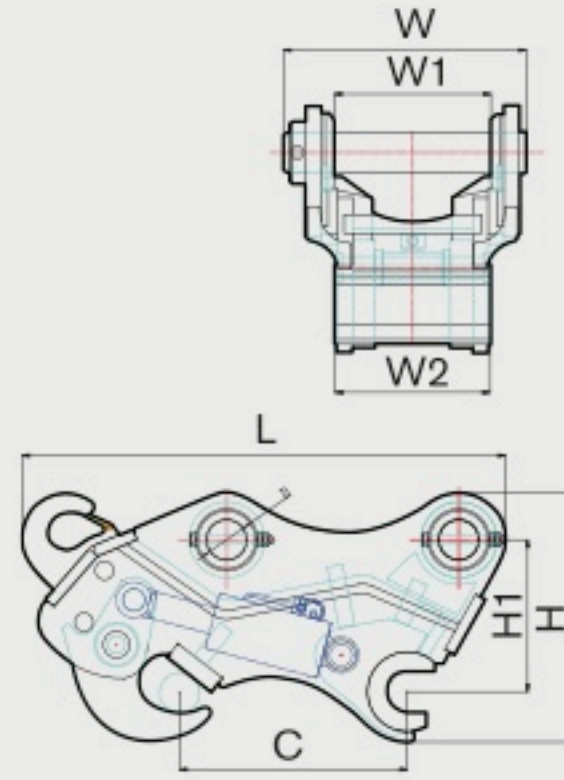

### Compactor

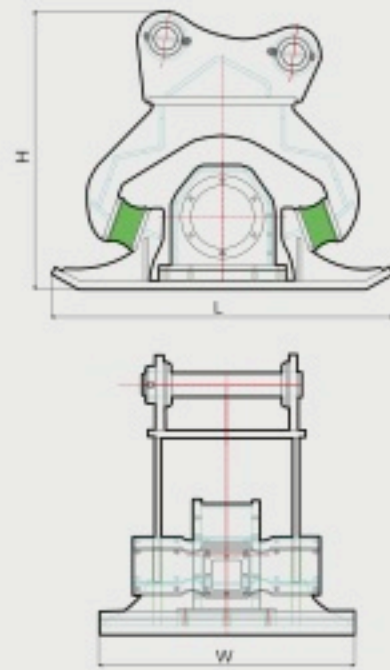

#### Standard Specification

Description / Model	UNIT	60	80	100
Impulse Force	ton	7	15	17
Hydraulic Flow	rpm	600 ~ 2000	600 ~ 2000	600 ~ 2000
Capacity	cc / rev	63	80	100
Pressure	kg/cm <sup>2</sup>	150 ~ 250	150 ~ 250	180 ~ 210
Measurement	L x W (mm)	1,145 x 700	1,250 x 850	1,350 x 950
Height	H (mm)	850	1,100	1,100
Width	W (mm)	700	850	950
Applicable Carrier Weight	ton	16 ~ 22	18 ~ 26	28 ~ 35
	lbs	35,270 ~ 48,500	39,683 ~ 57,320	61,729 ~ 77,161

#### Benefits

- Proper high-quality oil pressure motor to all types of models
- All-in-one block oil flow control valve
- Highly effective in hardening the narrow ditch

### Shears

#### Standard Specification

Description / Model	UNIT	800R	1000R
The gross weight	kg	1,900	2,750
Total Length	mm	2,090	2,320
The whole width	mm	1,300	1,500
The maximum angular aperture	mm	500	550
Cutter length	mm	350	580
Cutter ability	ton	190	360
Applicable pressure	bar	280	300
Applicable flux	lpm	200	250
Applicable Carrier Weight	ton	18 ~ 26	28 ~ 35
	lbs	39,683 ~ 57,320	61,729 ~ 77,161

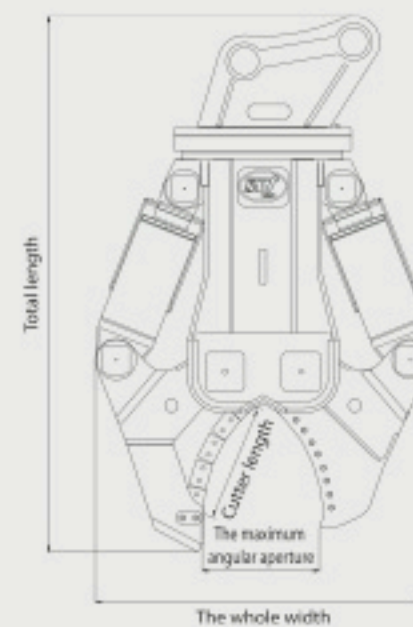

#### Benefits

##### Highly efficient iron scrap shears

- It has superior ability to cut iron, pipe, beam by using HARDOX600 cutter edge.

## Crushers

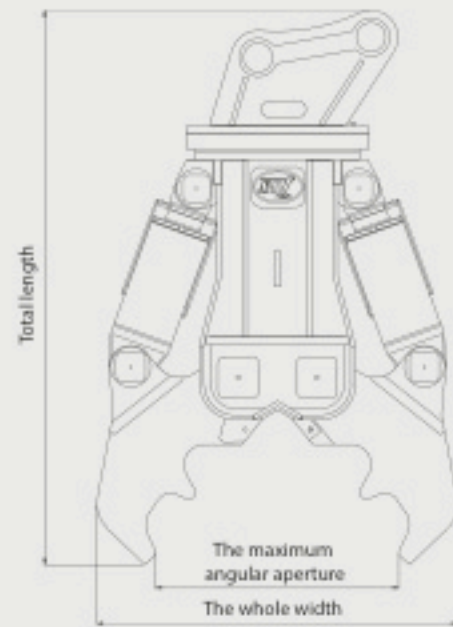

### Benefits

#### Strong crushing strength, excellent operation ability!

- Mighty power equipped with full-sized cylinder.
- Light weight and outstanding durability equipped with HARDOX600.



### Standard Specification

Description / Model	UNIT	800R	1000R
The gross weight	kg	1,900	2,750
Total Length	mm	2,100	2,470
The whole width	mm	1,300	1,600
The maximum angular aperture	mm	900	1,100
Cutter length	mm	170	200
Cutter ability	ton	108 x 2	127 x 2
Applicable pressure	bar	280	320
Applicable flux	lpm	150 ~ 250	200 ~ 300
Applicable Carrier Weight	ton	18 ~ 26	28 ~ 35
	lbs	39,683~57,320	61,729~77,161

## Pulverizer

### Standard Specification

Description / Model	UNIT	800	1000
The gross weight	kg	1,900	2,750
Total Length	mm	2,090	2,320
The whole width	mm	1,300	1,500
The maximum angular aperture	mm	500	550
Cutter length	mm	350	580
Crushing ability	ton	190	360
Applicable pressure	bar	280	300
Applicable flux	lpm	200	250
Applicable Carrier Weight	ton	18 ~ 26	28 ~ 35
	lbs	39,683~57,320	61,729~77,161

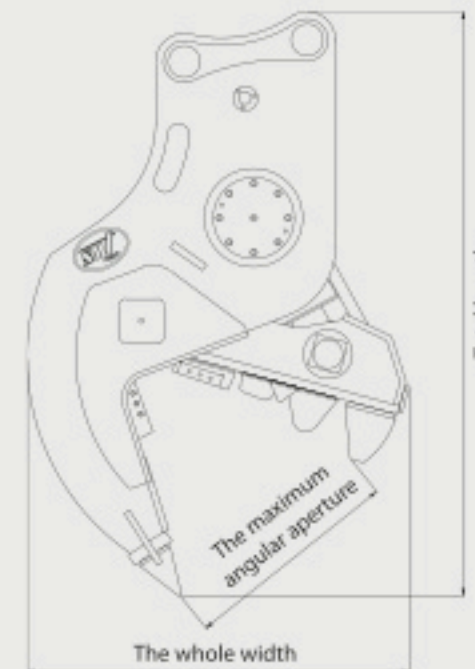

### Benefits

#### Strong crushing strength, excellent operation ability!

- Mighty power equipped with full-sized cylinder.
- Light weight and outstanding durability equipped with HARDOX600.

## Wood Grabs

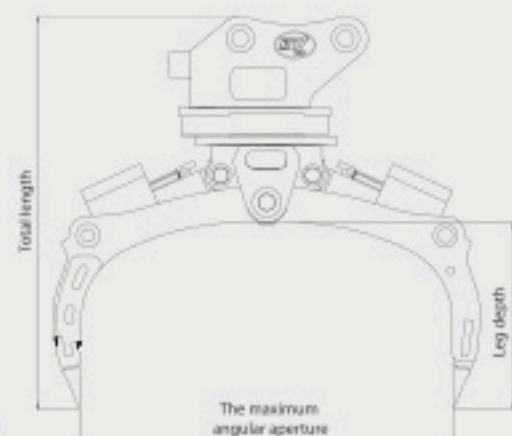

### Benefits

#### The highest technology, the best product

- 360 degree rotation
- It has light weight and outstanding durability, equipped with hard-faced material.

### Standard Specification

Description / Model	UNIT	550R	600R	800R	1000R
The gross weight	kg	250	680	1,000	1,600
Total Length	mm	1,000	1,300	1,700	2,300
The maximum angular aperture	mm	1,000	1,400	1,800	1,800
Leg depth	mm	450	600	700	800
Applicable pressure	bar	200	200	200	300
Applicable flux	lpm	35 ~ 65	80 ~ 140	130 ~ 180	180 ~ 260
Applicable Carrier Weight	ton	4 ~ 7	11~16	18 ~ 26	28 ~ 35
	lbs	8,818 ~ 15,432	24,250~35,274	39,683~57,320	61,729~77,161



# **INDEPENDENT** **BREAKERS**

**BREAKING POWER WHEN IT COUNTS!**



**Address:** 150 Schuler Drive  
Bardstown, Ky 40004

**TEL.** (502) 354-5534 / (502) 348-7573  
**URL** <http://www.independentbreakers.com/>  
**E-mail** [sales@independentbreakers.com](mailto:sales@independentbreakers.com)

Contact